

POSITION ECG48-1 GASKET ON END OF VALVE SO GASKET COVERS UPPER PILOT HOLE AND OPENS LOWER PILOT TO VALVE, SIDE 'B' ONLY

POSITION ECG48 GASKET ON END OF VALVE SO GASKET COVERS ALL PILOT HOLES, SIDE 'A' ONLY

NOTES:
1) ALWAYS GIVE VALVE MODEL AND PART NUMBER WHEN ORDERING PARTS.

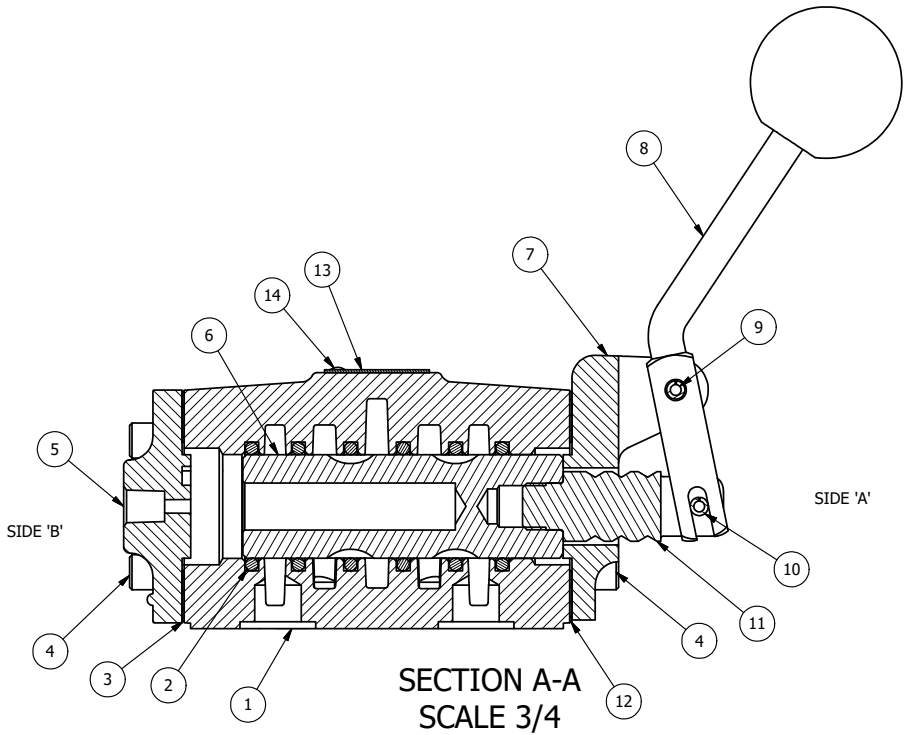

| | | | |
|-----|-----|---------|--|
| 15 | 1 | SPK-4 | KIT - SUBPLATE MOUNT, 1/2" SUBPLATE VALVES |
| 14 | 2 | V-212 | SCREW, #2 X 3/16 DRIVE, TYPE U, OVAL HEAD, STAINLESS STEEL |
| 13 | 1 | AN-115 | NAMEPLATE, BLANK, FOR HE,KE,KD,RR,D,CR,PP,SR,SS VALVES |
| 12 | 1 | ECG48 | GASKET - END CAP, 1/2", 3/4" & 1" VALVE |
| 11 | 1 | SC4-3 | CLEVIS - 3 POS. DETENT, 1/2" VALVE |
| 10 | 1 | V-7 | PIN, ROLL 3/16 X 11/16, STEEL, FOR 1/4 THRU 1/2" HAND, FT & CAM V |
| 9 | 1 | V-10 | PIN, ROLL 3/16 X 7/8, STEEL |
| 8 | 1 | HL4-9C | HAND LEVER ASSEMBLY, CURVED LEVER, 1/2" VALVE |
| 7 | 1 | FE4-1 | END CAP - HAND & FOOT, 380 AL, 1/2" VALVE |
| 6 | 1 | S4 | SPOOL - STANDARD, 2 POS, CLSD CTR, 1/2" VALVE |
| 5 | 1 | PEC48 | END CAP, PILOT, 380 AL, 1/2", 3/4" & 1" VALVES |
| 4 | 8 | V-46 | SCREW, 1/4-20 X 3/4, SOCKET HEAD CAP |
| 3 | 1 | ECG48-1 | GASKET - END CAP, LOWER PILOT, 1/2", 3/4" & 1" VALVE |
| 2 | 6 | V-6 | O-RING, BUNA-N, 70 DURO, AS-216, (REF 1-1/8 X 1-3/8 X 1/8), 1/2" VALVES, 1" SUBPLATE |
| 1 | 1 | BP4-4 | BODY, 1/2" SUBPLATE, LOWER & UPPER PILOT |
| FLG | QTY | PART NO | DESCRIPTION |

LIMITS ON DIMENSIONS
UNLESS OTHERWISE SPECIFIED
2-PL DECIMAL ± .01
3-PL DECIMAL ± .005
FRACTIONAL ± 1/64
ANGULAR ± 1/2°



DRAWN: RMckenna DATE: 8/24/2015 CHECKED: KWaite DATE: 8/24/2015
SCALE: 3/4 SHEET: 1 OF 1 RELEASED: HWomack DATE: 8/24/2015

TITLE: 1/2" SUBPLATE, LEVER, 2 POS, FRICTION POS, PILOT RTRN, CURVED LEVER
PART NO.: HR4PC
REV.:

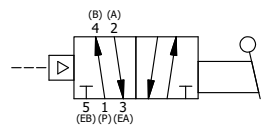

THE INFORMATION CONTAINED WITHIN THIS DOCUMENT IS PROPRIETARY TO AAA PRODUCTS AND MAY NOT BE DISCLOSED WITHOUT PRIOR WRITTEN CONSENT

P:\Engineering\product\Valve Assembly\Level\HR4\HR4PC.dwg