

DRIVE UNIT SITS FLAT AGAINST THIS SURFACE

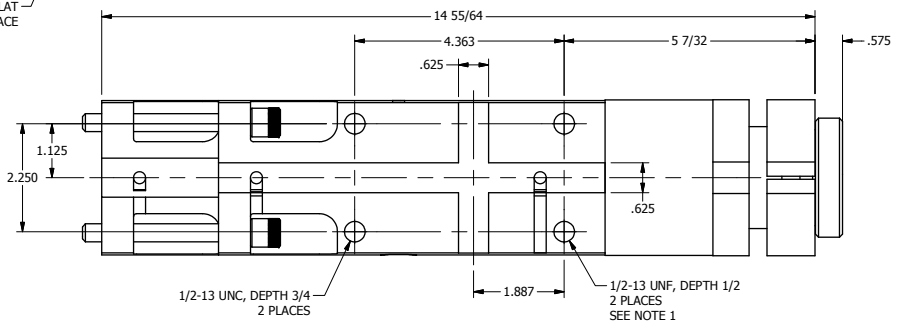
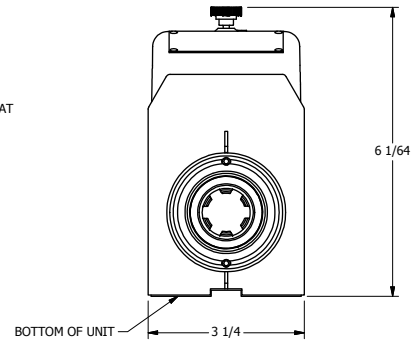
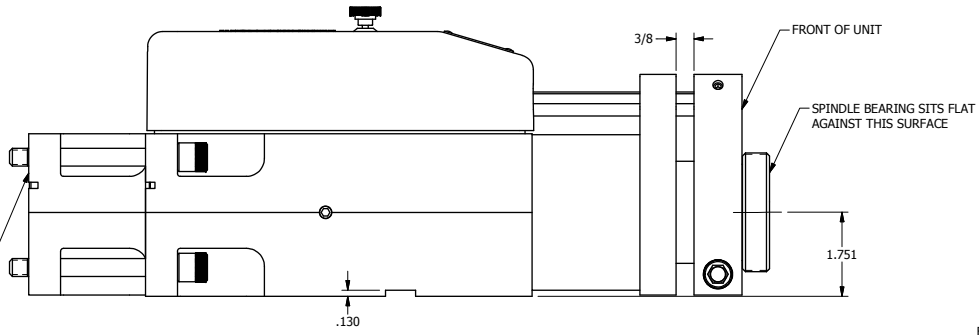

NOTES:  
 1) MAXIMUM DEPTH OF THE TWO FRONT MOUNTING HOLES IS 1/2". BOLTS LONGER THAN THIS WILL DAMAGE THE INNER SEAL TUBE.

	<b>AAA PRODUCTS INTERNATIONAL</b> 7114 Harry Hines Blvd Dallas, TX 75235	TITLE: MAIN DRILL UNIT SECTION, LARGE BEARING, USED W/SPINDLE & MOTOR SECTION	DRAWING NO.: <b>DIM_3DLB</b>
--	--	---	---------------------------------

THE INFORMATION CONTAINED WITHIN THIS DOCUMENT IS PROPRIETARY TO AAA PRODUCTS AND MAY NOT BE DISCLOSED WITHOUT PRIOR WRITTEN CONSENT